

COUNTER CABINET SERIES

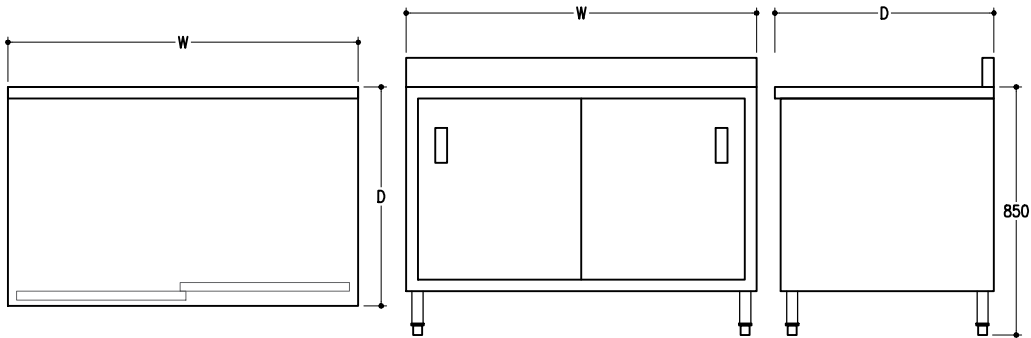
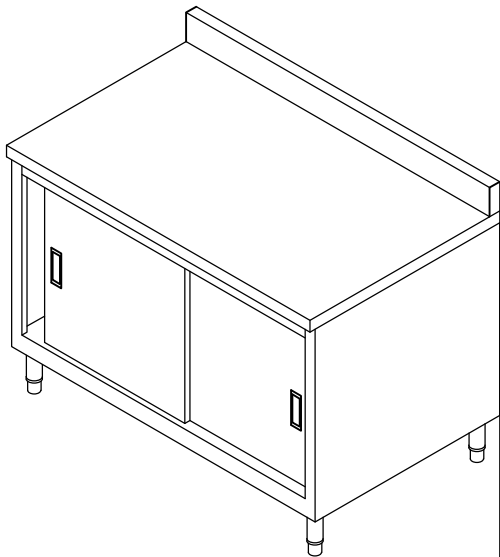

TOP VIEW

FRONT VIEW

SIDE VIEW

DESCRIPTION

Code Item	CSL-12-B	CSL-15-B
Main Function	Counter cabinet made of rustproof high quality iron and made to last. Using this item for storing your food and equipment with sliding door, makes everything easier and efficient.	
Dimension in mm ( W x D x H )	1200 x 750 x 850/950	1500 x 750 x 850/950
Net Weight	41.2 Kg	50.4 Kg
Working Capacity	8.520 Cm <sup>2</sup>	10.650 Cm <sup>2</sup>
Features	Neutral Working Surface, Adjustable Feet, Sliding Doors, Shelf, Backsplash	